

**Inlet System Features**

**Typical fixing details - Inlet systems**

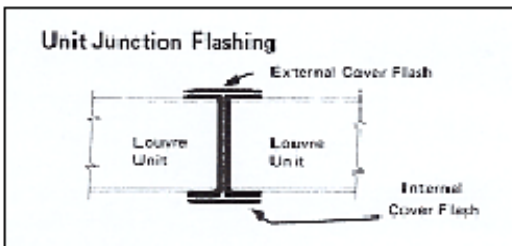
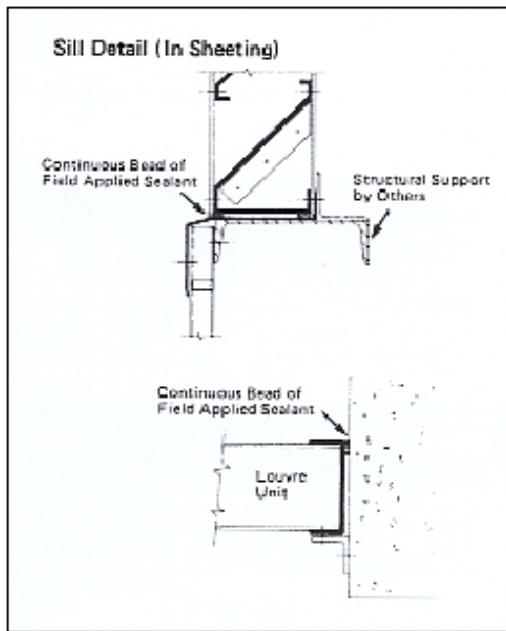
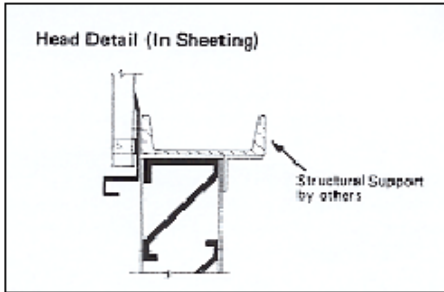

Allow 3mm - 5mm clearance around louvre perimeters. Maximum louvres widths not to exceed 1500mm for single modules unless additional support is provided.

The illustrations above are from a series available from your nearest RVI Service Centre.

**Minimal Maintenance**

Robertson Inlet Louvres can be manufactured from Robertson's unique Versacor barrier coated material, giving maximum resistance to corrosion.

**Louvre Width**

Robertson louvres are available in widths from 400 mm to 2000 mm for single units. Where larger openings are involved, use multiples of suitably sized units.

**Opening Size**

Where louvres are to be installed into steelwork, allow 3 mm clearance around the unit. Where louvres are to be installed into brickwork, allow 5 mm clearance around the unit.

**Free Inlet and Pressure Drop**

In the design of any ventilation system the pressure drop through the louvres is one of the critical performance considerations whilst the louvre free area is not meaningful in itself. The exact percentage of free area to the overall louvre area is a function of both the unit height and width, and can be calculated quite simply. For the actual pressure drop through the louvres, refer to the appropriate pressure drop chart, available from your nearest RVI Service Centre.

**Optional Accessories**

**Bird and Insect Screens**

Robertson louvres are available with either bird or insect screens, manufactured from materials compatible with those used for the louvre unit. The screens are generally fitted to the internal face of the louvre unit.

**Actuating Mechanism**

All Robertson Operating Louvres can be manually, electrically or pneumatically operated, and can be provided with control panels if required.

